

# Strut *Foot*

Universal Flat Roof Support System



# About Us

StrutFoot have been manufacturing supports for over 20 years. In the last 10 years we have developed non-penetrating flat roof supports specifically for the HVAC market to enable customers to fix plant and roofing equipment to the roof without the need to drill.

We are unique in the fact that we produce and fabricate everything; the feet are moulded in our premises, the steel is fabricated in house, drawings and engineering all produced in house & surveys completed by our engineers.

Our estimated recycling will be 400 tonnes in 2020, rising to 600 tonnes in 2021. This is made up of HDPE plastic and rubber truck tyres.

## Contents

<b>StrutFoot</b> H Frame Kits	1
<b>StrutFoot</b> LD Frames	2
<b>StrutFoot</b> Base & Plus	3
<b>StrutFoot</b> HD Frames	4
<b>StrutFoot</b> SFR Rubber Feet	5
<b>StrutFoot</b> SFR Anti Vibration & AV Pads	6
<b>StrutFoot</b> SFR Mini Split & Angled Pads	7
<b>StrutFoot</b> Fleeces	8
<b>StrutFoot</b> Duct Adjuster	9
<b>StrutFoot</b> Beam	10
<b>StrutFoot</b> Quad	11
<b>StrutFoot</b> StepOver	12
<b>StrutFoot</b> Access	13
<b>StrutFoot</b> Case Study	14-15
<b>StrutFoot</b> Notes	16

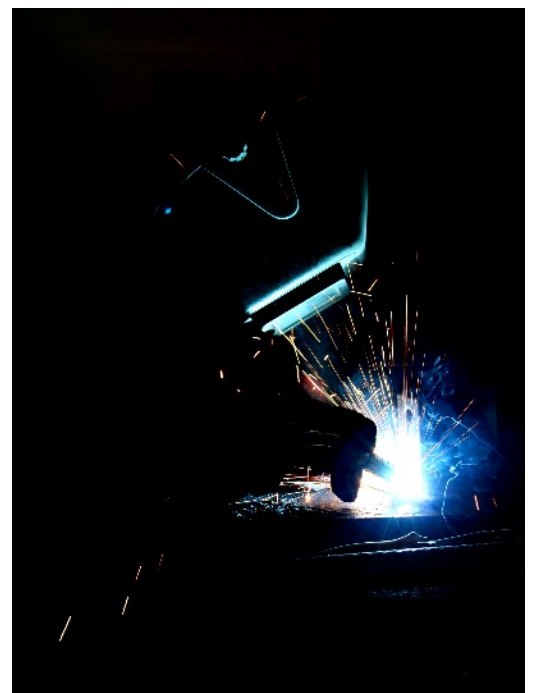



StrutFoot

The H Frame Kit is a quick and easy solution to support all cable management, ducting and pipework.

H Frames are supplied in box form.

They are designed to use channel which is not supplied. As a module our manufacturing can fabricate the H Frames in house to speed up the process of installation on site.



### H Frame Kit Includes

Product	Quantity
Plastic Feet	x 2
Fixing Kit	x 1

### Product Information

Part No	Feet Size (mm)	Product Weight (kg)	Frame S.W.L (kg)
SF3305	305	4.1	350
SF3500	500	10	500

- High Density Polyethylene (HDPE)
- Designed to fit channel (not supplied)
- No penetration of waterproof roof membrane
- Anti-vibration pads pre attached to feet
- Off site cutting & delivery service available
  - Available in 305mm & 500mm
  - S.W.L for R305mm - 350Kg
  - S.W.L for R500mm - 500Kg

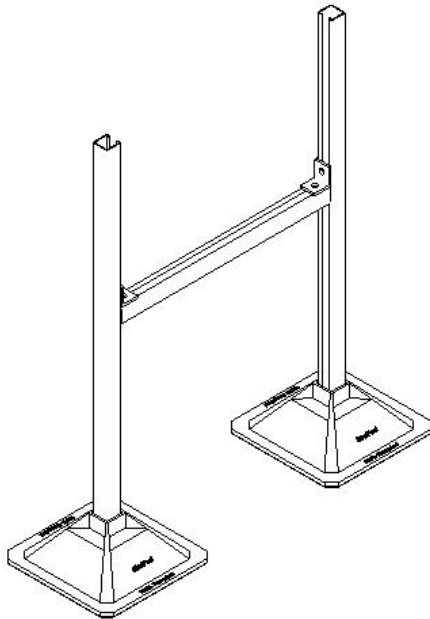



## The **StrutFoot**<sup>TM</sup> Flat Roof Support System, offering total flexibility for design, layout & installation.

- Channel framework provides strength & convenience for cable management installation
- Cross compatibility with all channel type brackets
- Fast & economical systems for mounting M&E services, Air Conditioning & Refrigeration on flat roofs
- Easy to install for individual products or complete installations
- No penetration of waterproof roof membrane
- Standard & bespoke configurations
- Anti-Vibration pads pre attached to feet
- Feet & blocks available separately

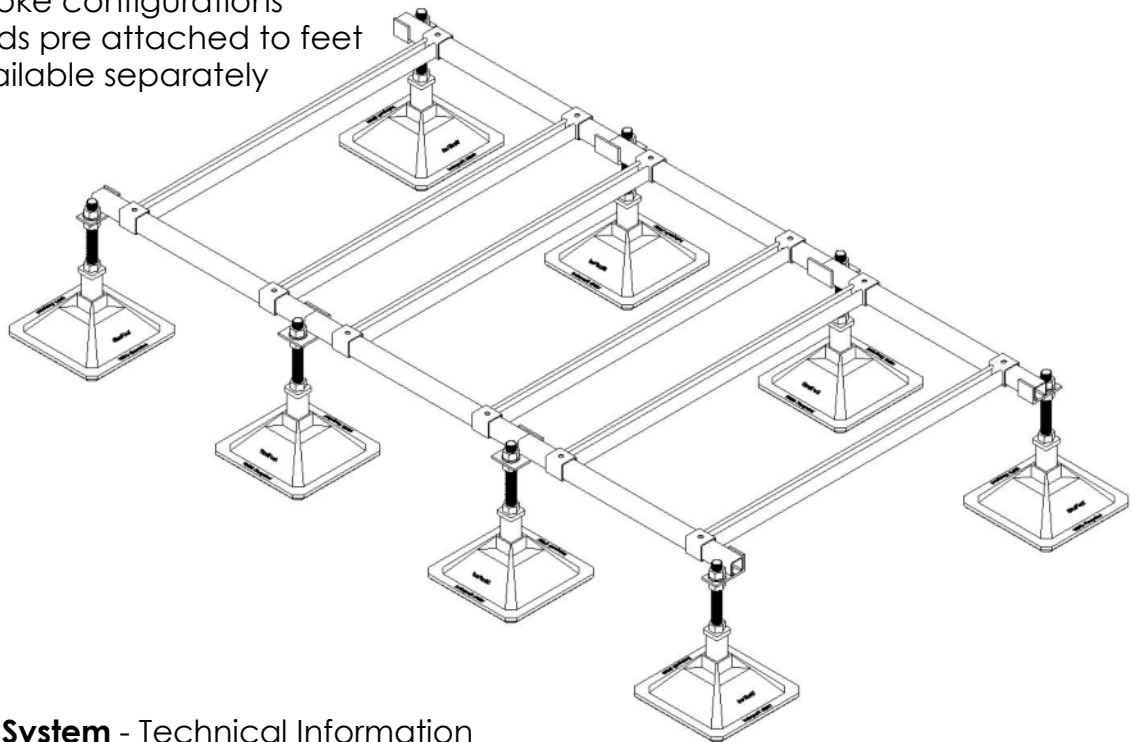

### **StrutFoot** Support System - Technical Information

Part No	Product Description	Complete Leg Assembly	Sliding Arm	Side Rails (mm)	Sliding Arms (mm)	Product Weight (kg)	Max S.W.L (kg)
SF1302	StrutFoot 2	4	2	1000	1300	32	700
SF1304	StrutFoot 4	6	4	2000	1300	54	1050
SF1306	StrutFoot 6	8	6	3000	1300	78	1400
SF1308	StrutFoot 8	10	8	4000	1300	101	1750
SF1310	StrutFoot 10	12	10	5000	1300	124	2100
SF1312	StrutFoot 12	14	12	6000	1300	148	2450



**StrutFoot Base & StrutFoot Plus Combined**

- Easy to adapt & extend in line or side on to suit most installations, extend to any length
- Channel framework provides strength & convenience for cable management installation
- Cross compatibility with all Unistrut type brackets
- Fast & economical systems for mounting M&E services, Air Conditioning & Refrigeration on flat roofs
- Easy to install for individual products or complete installations
- No penetration of waterproof roof membrane
- Non drill system

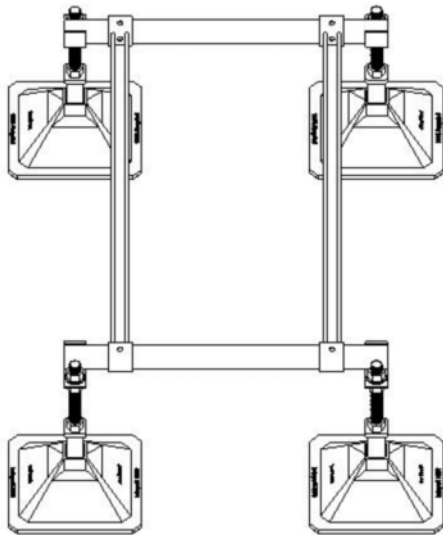

**StrutFoot Base System**

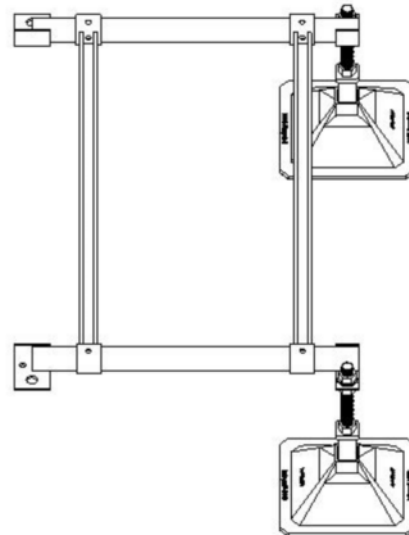

**StrutFoot Plus System**

### StrutFoot Support System - Technical Information

Part No	Product Description	Complete Leg Assembly	Sliding Arm	Side Rails (mm)	Sliding Arms (mm)	Product Weight (kg)	Max S.W.L (kg)
SF1002	StrutFoot Base	4	2	1000	1300	32	700
SF1004	StrutFoot Plus	2	2	1000	1300	26	350



StrutFoot's HD System has been designed to carry large Air Handling Units, chiller systems and other heavy plant loads. The system is versatile and fast to install, as with the rest of our range the HD system is manufactured in house.

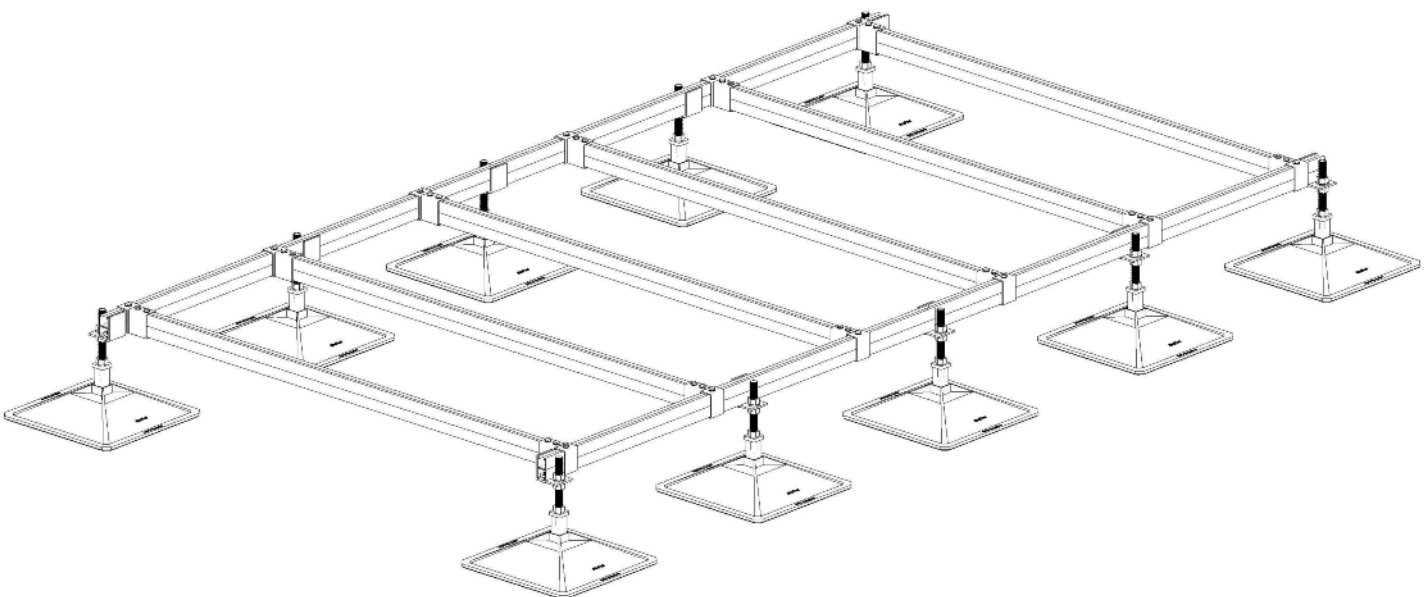

Welding to ISO 9606-1

Galvanising to BS EN ISO 1461:1999

CE 1090

ISO 9001 Quality & ISO 14001

Environmental Certification Number 1753

Channel to BS6946



**StrutFoot** SFR Rubber Feet

The SFR range of rubber feet are used for pipework and cable trays on non-penetrable roof installations. The eco friendly feet are fitted with 41x21 aluminium channel moulded into the feet, giving the feet a very strong pull out resistance and also anti corrosive properties.

Part No	Model	Length (mm)	Width (mm)	Height (mm)	Max Loading Per Foot (kg)
SF4025	SFR250	250	180	95	160
SF4040	SFR400	400	180	95	240
SF4060	SFR600	600	180	95	450
SF4010	SFR1000	1000	180	95	645
SF4525	SFR250 Low	250	130	50	160
SF4540	SFR400 Low	400	130	50	240

**MATERIAL SPECIFICATION**

SBR-Recycled Rubber. Bound using a ratio of high quality moisture curing Polyurethane Pre-Polymer. BS7188:1989+A2:2009 and BS EN1176-7:2008

**METAL PROFILE**

Aluminium strut 41mm x 21mm profile compatible with strut fixings.

**WORKING CONDITIONS**

Suitable for internal or external applications in temperatures between -40°C to +80°C. BSEN60068-2-14





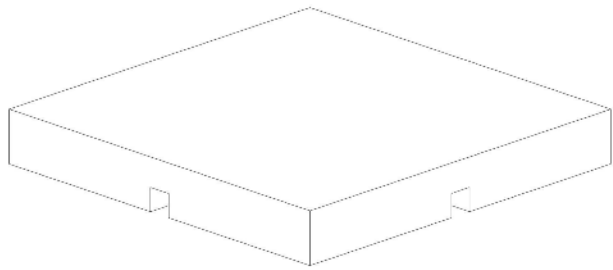

## StrutFoot SFR Vibro Mats

Part No	Description	Length (mm)	Width (mm)	Height (mm)	Packaged Weight (kg)
SF4091	SFR Vibro Mat 330	330	330	45	4
SF4092	SFR Vibro Mat 500	500	500	45	7.5



## StrutFoot SFR AV Pads

Part No	Description	Length (mm)	Width (mm)	Height (mm)	Packaged Weight (kg)
SF4081	SFR 300mm AV Pad	300	300	6	0.5
SF4082	SFR 500mm AV Pad	500	500	6	0.85



# StrutFoot SFR Mini Split Kits

Part No	Description	Length (mm)	Width (mm)	Height (mm)	S.W.L per Kit (kg)	Packaged Weight (kg)
SF4066	Mini-Split Kit SFR 600	600	180	95	900	13
SF4011	Mini Split Kit SFR 1000	1000	180	95	1290	21.6

### Kit Includes

Rubber Feet	x 2
Fixing Kit	x 2

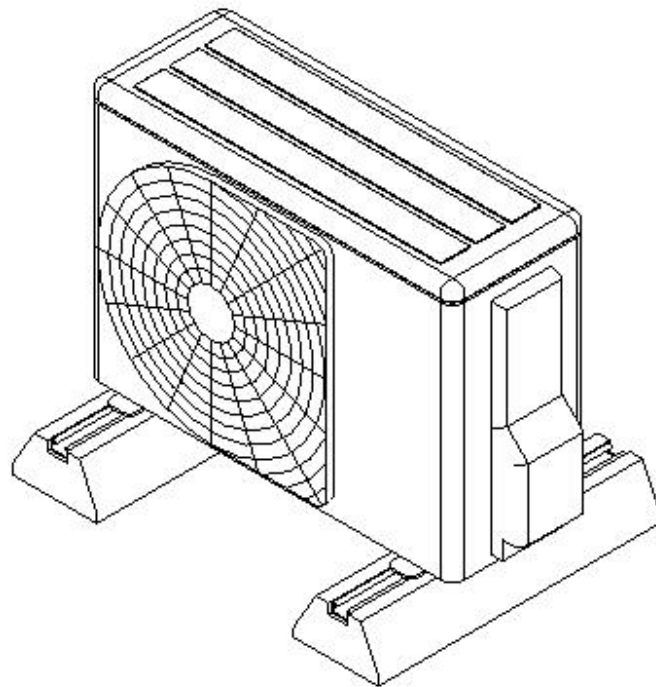

## StrutFoot Angled Rubber Pads

Part No	Description	Length (mm)	Width (mm)	Packaged Weight (kg)
SF4071	SFR 305 2.5 Degree	305	305	1.9
SF4072	SFR 500 2.5 Degree	500	500	6
SF4073	SFR 305 5 Degree	305	305	1.6
SF4074	SFR 500 5 Degree	500	500	7.5

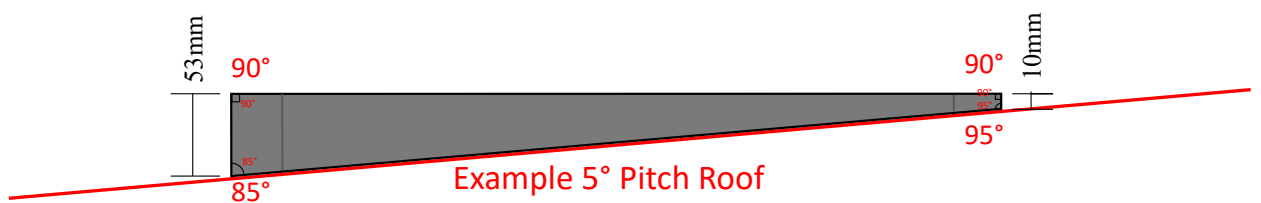



The StrutFoot Fleece has been designed to fit both our plastic feet as well as our rubber feet.

They are used for in between asphalt and PVC roof membrane surfaces. This will therefore help prevent polymer migration between the plastic and rubber products.

Product Information			
Part No.	Length (mm)	Width (mm)	Thickness (mm)
SF9010	215	215	4
SF9011	315	315	4
SF9012	515	515	4
SF9013	250	200	4
SF9014	400	200	4
SF9015	600	200	4
SF9017	1000	200	4



StrutFoot's new adjustable ducting support offering flexibility and quick installation. The height of the duct adjuster can easily be changed using the thumb screw provided.

Product Information				
Part Code	Feet Size (mm)	Quantity	Brackets Quantity	Packaged Weight (kg)
SF5822	305	x 5	x 5	10
SF5844	500	x 2	x 2	13.5

## 87% quicker than standard installations

- Non-penetrative duct support
- Quick and easy to install
- 305mm and 500mm feet available
- Feet incl. Adhered anti-vibration pad
- Comfortable height adjustment using thumb screw
- Height adjustable between 220 - 400mm
- Total height 600mm from floor
- Static max. Load 80kg
- 8mm stud for ducting support rings & clamps



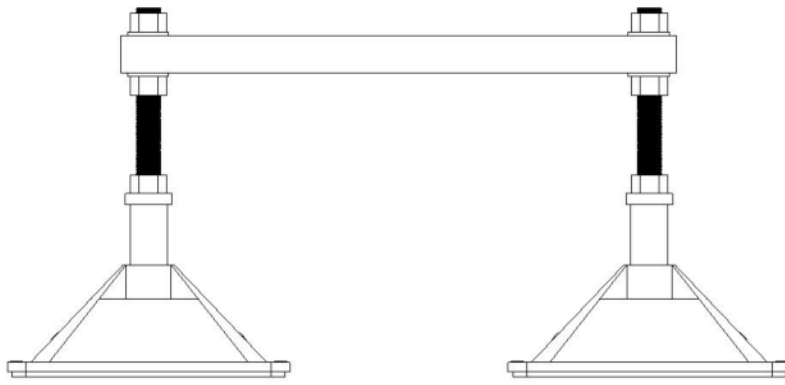

The StrutFoot Beam is an adjustable heavy duty support system which is typically used with heavy Air Handling Units (AHU's) or when we have to pick up existing beams on the roof.

Part No	Feet Size (mm)	Beam Size (mm)	Product Weight (kg)	Frame S.W.L (kg)
SF7500	305	500	9.5	350
SF7010	305	1000	12.4	350

- Adjustable heavy duty support system
- Used to pick up existing support beams
- Used to support heavy AHU's
- Supplied with fixings
- Supplied to fit required size
- Hot dip galvanised (HDG) framework
- Available in 305mm & 500mm
- S.W.L for 305mm - 350Kg
- S.W.L for 500mm - 500Kg

StrutFoot Beam Includes	
Product	Quantity
Leg Assembly	x 2
Beam	x 1
Brackets	x 2



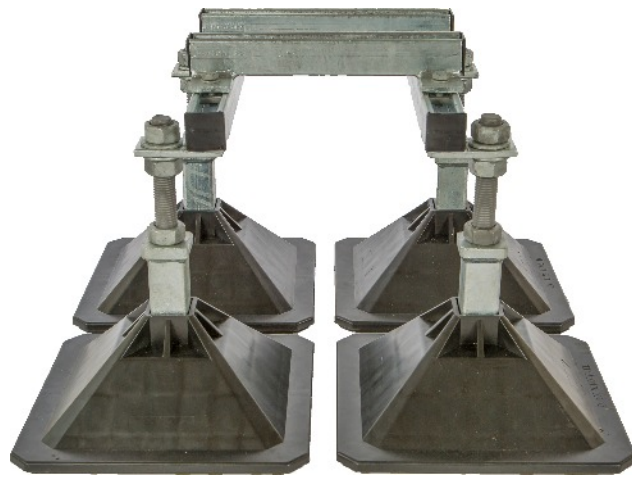

The quad system is a quick and easy solution to support large/heavy AHU's, chillers and plant rooms.

All the framework on each Quad system is HDG ensuring there will be no rust/corrosion when installed outside. It can be supplied using either our R305 or our R500 plastic feet.

We manufacture a welded framework for both our adjustable and fixed quad to ensure strength and minimize the deflection in the strut.

### StrutFoot Quad Fixed

Part No	Description	Feet Size (mm)	S.W.L (kg)
SF5305	StrutFoot Quad R305 Fixed	305	700
SF5500	StrutFoot Quad R500 Fixed	500	1000

### StrutFoot Quad Adjustable

Part No	Description	Feet Size (mm)	S.W.L (kg)
SF6305	StrutFoot Quad R305 Adjustable	305	700
SF6500	StrutFoot Quad R500 Adjustable	500	1000



StrutFoot offer a full range of StepOvers to their customers. Each StepOver is complete with 1000mm wide steps, 1000x1000mm platform and the handrail.

With our in house design and manufacturing StrutFoot can supply and install bespoke access to meet the customer specifications.

The framework on all of our access is HDG (hot dipped galvanised) ensuring there will be no rust. All of the leg assemblies supplied with the StepOver are adjustable and supplied with our R305 plastic feet.

All of the systems below are available from stock and are easily installed.

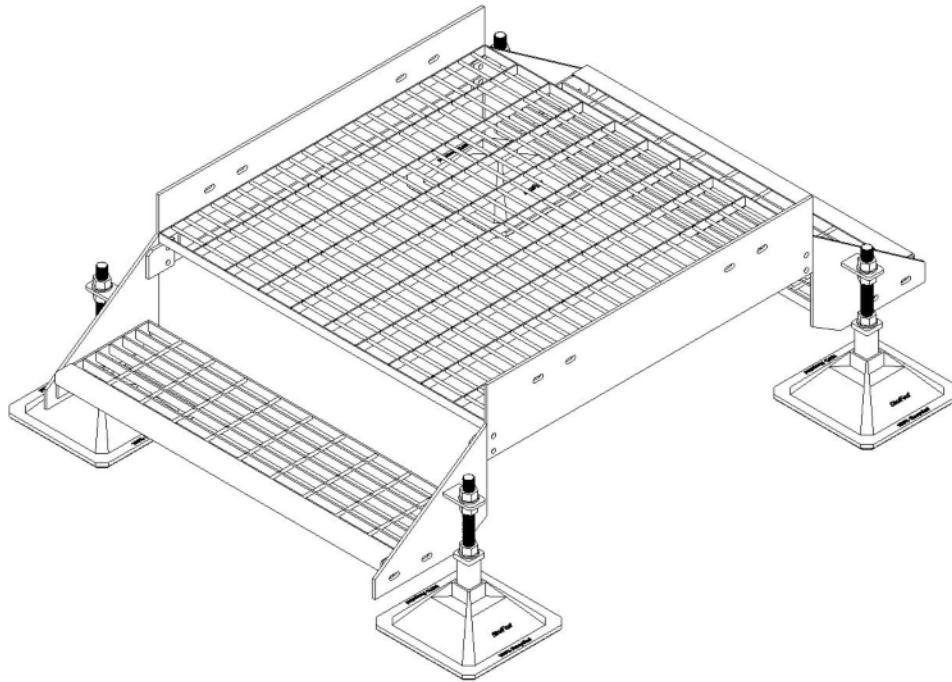

### StrutFoot StepOver's

Part No	Description	Foot Size (mm)	Platform Size (mm)
SF8010	SFA111 - 1 Step System	305	1000x1000
SF8020	SFA212 - 2 Step System	305	1000x1000
SF8030	SFA313 - 3 Step System	305	1000x1000
SF8040	SFA414 - 4 Step System	305	1000x1000

### StrutFoot Platform

Part No	Description	Foot Size (mm)	Platform Size (mm)
SF8050	SFA555 - <b>StrutFoot</b> Platform	305	1000x1000

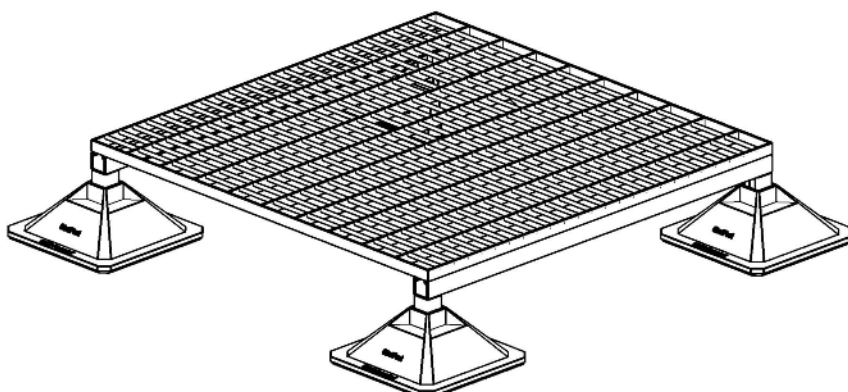

StrutFoot are the only supplier who currently design and manufacture bespoke access's in house. Our skilled design engineers also offer site survey's to design a bespoke roof top access to fit specific requirements. In addition, we can also complete the install of the system using our highly skilled fitters.

Material:

- HDG framework
- HDG/GRP open mesh flooring
- Handrail - key clamp & welded box section

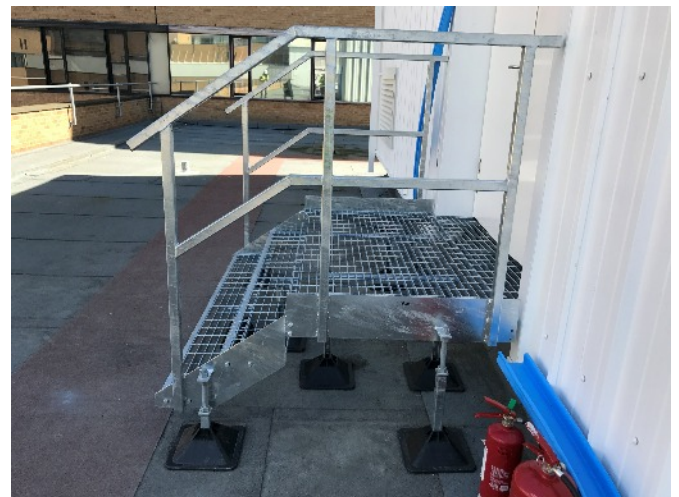
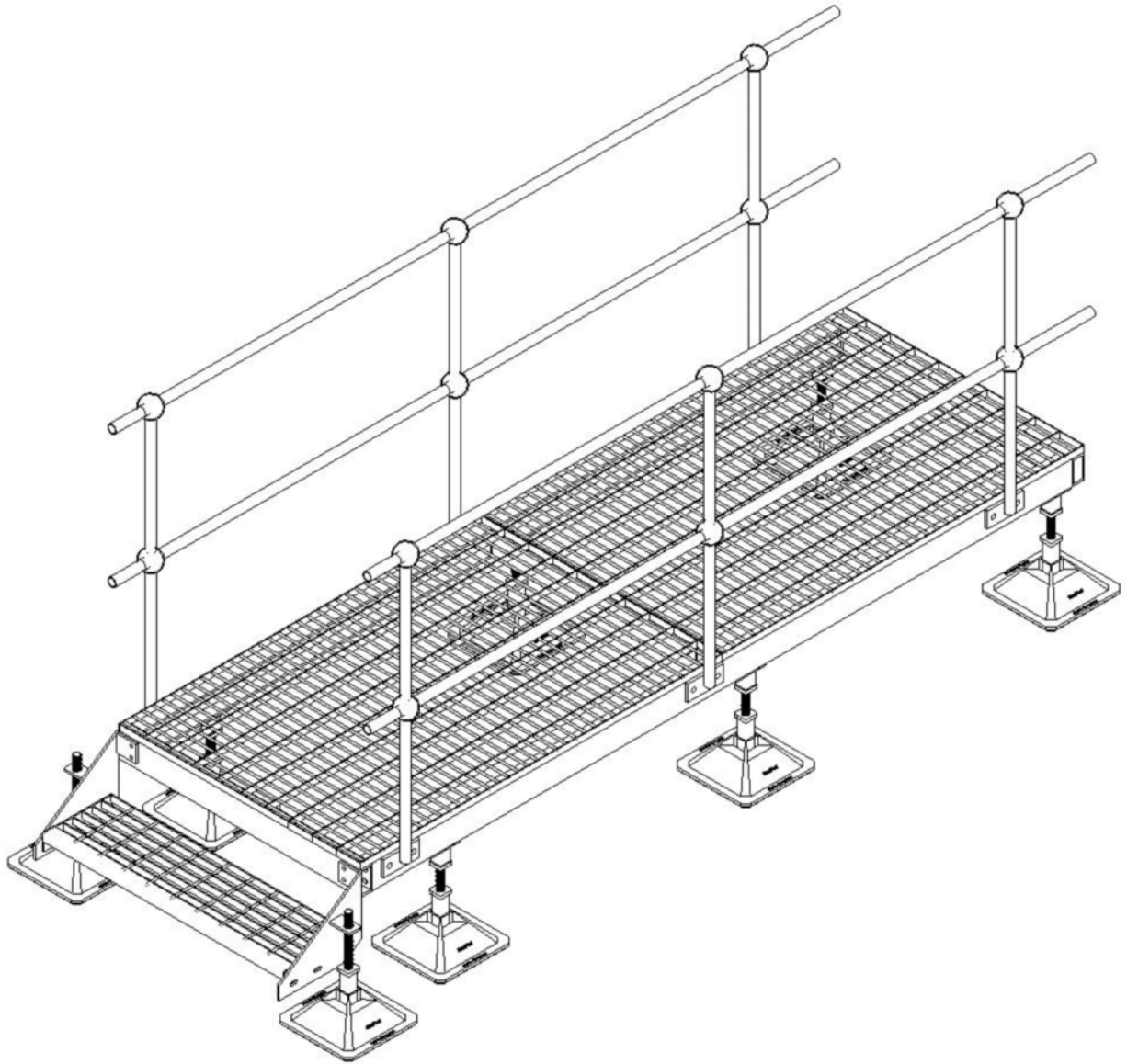





After originally supplying a HD frame to support a large AHU, we were then asked to quote, design and install a bespoke platform and three bespoke stepovers for the same project in Southampton.

The client sent us all the technical information regarding requirements for the access; e.g. dimensions and clearance required.

We managed to get it manufactured, galvanised, delivered and installed within 23 working days.





StrutFoot were tasked with designing roof top supports for AHUs, chillers and ductwork for a project in London.

The client issued us with the drawings and technical specifications for the project. Following a site survey we were able to offer a cost effective solution, designed, engineered and delivered to site in 5 working days to site.



After the installation of the StrutFoot frames, the final inspection was supervised by our Site Manager. Everybody involved was happy with what we delivered and we were offered the chance to both design and install the access for the same project.

The customer wanted the access to fit just above the ductwork which was already on the roof so StrutFoot completed another site survey to ensure we had the correct measurements for all of the 7 bespoke framework.

Everything was again manufactured in house and delivered to site.

StrutFoot then sent out an installation team to build the framework designed which was completed within 5 working days.





# **Strut** *Foot*

Universal Flat Roof Support System