

VIBRATION MANAGEMENT CORPORATION

3532-A EAST TC JESTER , BROOKWOOD BUSINESS PARK , HOUSTON , TEXAS 77018 , U.S.A

INTERNET ADDRESS: www.vimco.biz

MODEL	ROD / BOLT SIZE (inches)	CABLE DIA. (inches)	MAXIMUM DESIGN LOAD (lbs)
SCRSA-00-xx	1/4" - 1 1/4"	3/32	600
SCRSA-01-xx	1/4" - 1 1/4"	1/8	1100
SCRSA-02-xx	1/4" - 1 1/4"	3/16	2667
SCRSA-03-xx	1/4" - 1 1/4"	1/4	4400

ROD/ BOLT CODES	
CODE	SIZE (inches)
02	1/4"
04	3/8"
05	1/2"
06	5/8"
07	3/4"
08	7/8"
10	1"
12	1 1/4"

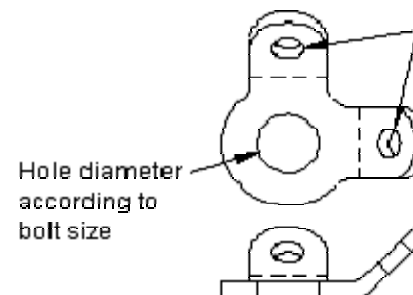

Hole diameters sized to accommodate 3/32" to 1/4" cable without the need for a thimble

NOTES

1. While ordering specify rod/bolt size code in place of "xx" e.g. for 1/8" cable with 3/8" bolt order SCRSA-01-04
2. Maximum load rating based on cable breaking strength.
3. Each SCRSA assembly is supplied with 1 or 2 oval sleeves (depending on application)
4. For best results use VIMCO model SCCT crimping tools.
5. Also available in retrofit models. Contact factory for information.

APPLICATION

- * For permanent attachment of cable brace to structure / equipment. Design for use with 7x19 strand core pre-stretched galvanized aircraft cable.

FEATURES

- * Complies with ASCE 19 and SMACNA Restraint Manual as required by FEMA, NEHRP, IBC, OSHPD, UNC, BOCA, SBCCI, other Building Codes
- * Permanent end fitting
- * Maintains break strength of cable and does not require thimbles
- * (2) SCRSA's can be stacked on single rod to make a 4-way brace
- * Simple installation

TYPICAL CONNECTION DETAILS

<p>CONNECTION TO EQUIPMENT / SUPPORT MEMBER</p>	<p>CONNECTION TO STRUCTURE (Concrete deck)</p>	<p>CONNECTION TO STRUCTURE (Steel beam)</p>
--	---	--

see reverse for typical applications

<p><u>Notes / Remarks :</u></p>	Project		<p>Title : SCRSA Seismic Cable Restraint System</p>	<p><u>Drawing no.</u> S-3100.32 Rev. 1</p>
	Client			
	Consultant			
	Representative			

VIBRATION MANAGEMENT CORPORATION

3532-A EAST TC JESTER , BROOKWOOD BUSINESS PARK , HOUSTON , TEXAS 77018 , U.S.A

INTERNET ADDRESS: www.vimco.biz

TYPICAL APPLICATIONS

